

Welcome to Radikal jung festival 2024!

We are glad that you're part of it!



## FAQs

### Why do I need a festival pass?

First of all: To be recognized as a member of the festival! Furthermore, the theatres' restaurant SCHMOCK offers two daily dishes (vegetarian/non-vegetarian) for festival members for 5,50 € each and drinks with a 20% discount. Please show your festival pass before ordering drinks and dishes and carry it with you during the whole festival!

## **Where is the canteen?**

We usually eat and gather at the theatre's restaurant SCHMOCK. For people who are part of Radikal jung 2024 there are special offers: two dishes of the day, one with and one without meat, 5,5 Euro each and drinks with a 20% discount. Please show your festival pass before ordering!

In the garden and in the lounge there is self service from the bar with a special festival menu and fixed prices for everyone. Cold drinks are served in plastic cups with 2 Euro deposit.

## **What are the opening hours of SCHMOCK?**

The SCHMOCK will open at 11 am and close at 11 pm everyday. You can order food in the following timeslots:

19.04. 11:30 am - 11:45 pm  
20.04. 2 pm - 11:15 pm  
21.04. 3 pm - 11 pm  
22.04. 11:30 am- 11 pm  
23.04. 11:30 am- 10:30 pm  
24.04. 11:30 am- 11 pm  
25.04. 11:30 am - 10:30 pm  
26.04. 11:30 am - 10:30 pm  
27.04. 2 pm - 11:30 pm

Please keep in mind that one hour prior to the performances the restaurant is packed with people and it may be difficult to have a quick meal. We recommend to eat beforehand or to order the food in advance. Pre-orders with advance payment no later than 8:30 pm at the bar in the restaurant.

The kitchen then places these plates under the thermal bridge when the kitchen closes.

## **Where is the stage entry?**

The stage entry is located at the back of the theatre on the south corner of the building. Entering the site through the iron gate in Zenettistraße you walk along the building until you reach the back door where the security team is located.

From the lobby you can enter the backstage area through a salmon pink door opposite the bar. The door opens if you push the button on the right side of the door.

## **Is there Wifi available?**

Yes! In the theatre there is WIFI available, called MVT-Gast, password: volkstheater

## **Where can I get help?**

Meet us at our Welcome Station everyday from 3 to 6 pm in the lobby, at the weekend from 4 to 6 pm—we're there for you with open hearts and ears for your questions and feedback!

## Site map

location: Tumblingerstraße 29 80337 München

stage entry: Zenettistraße 21 80337 München

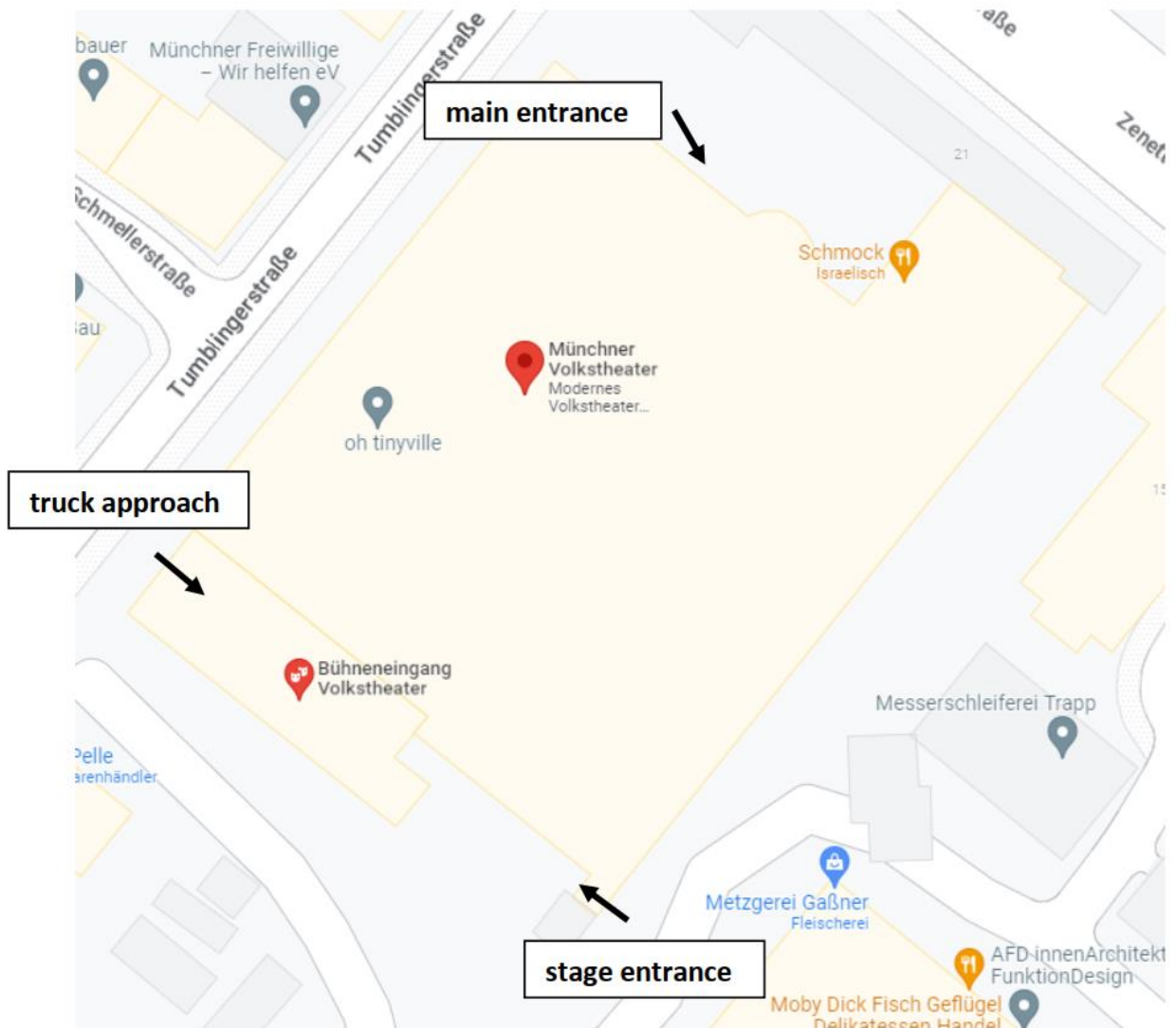

# volkstheater

ground floor:

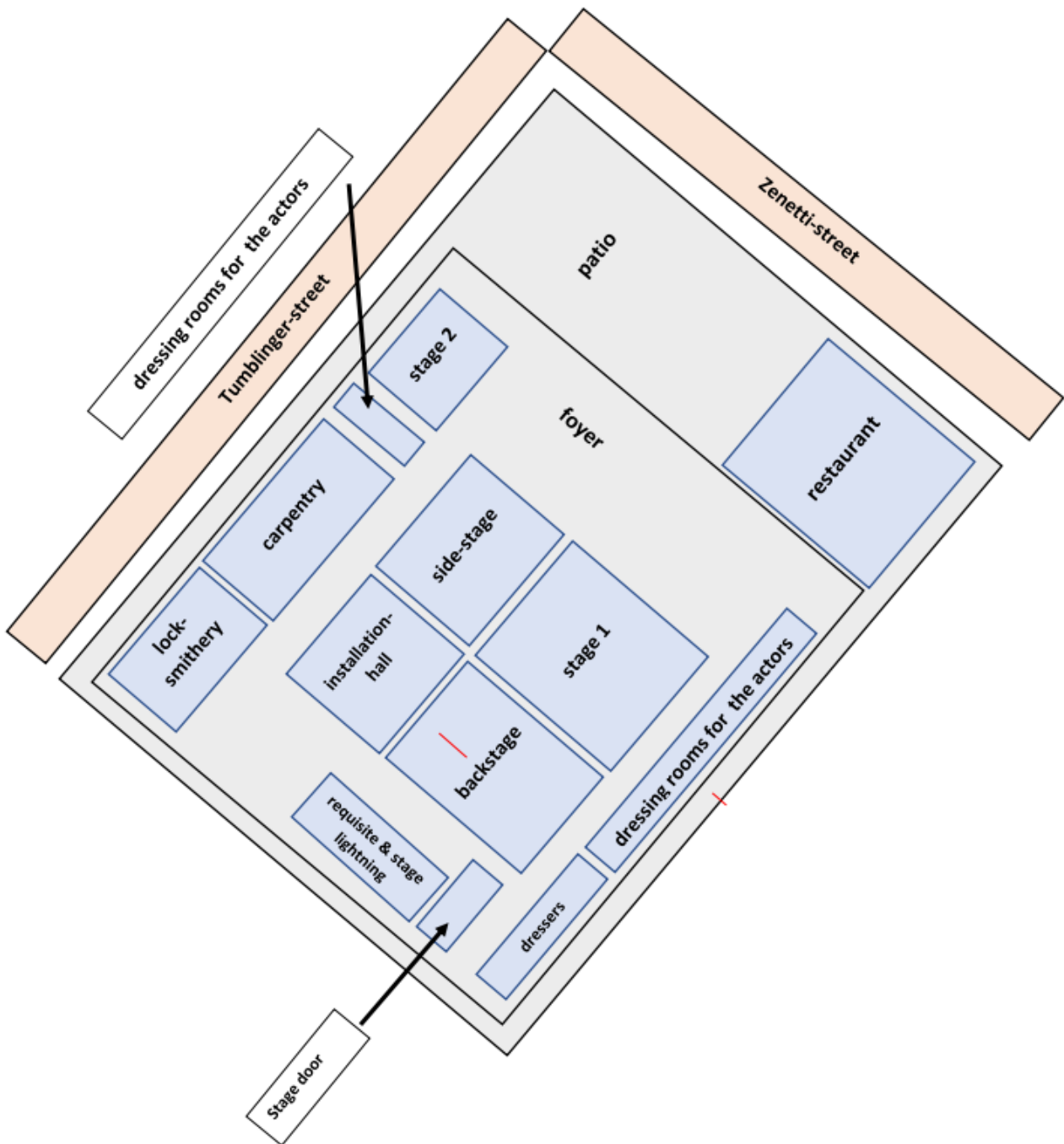

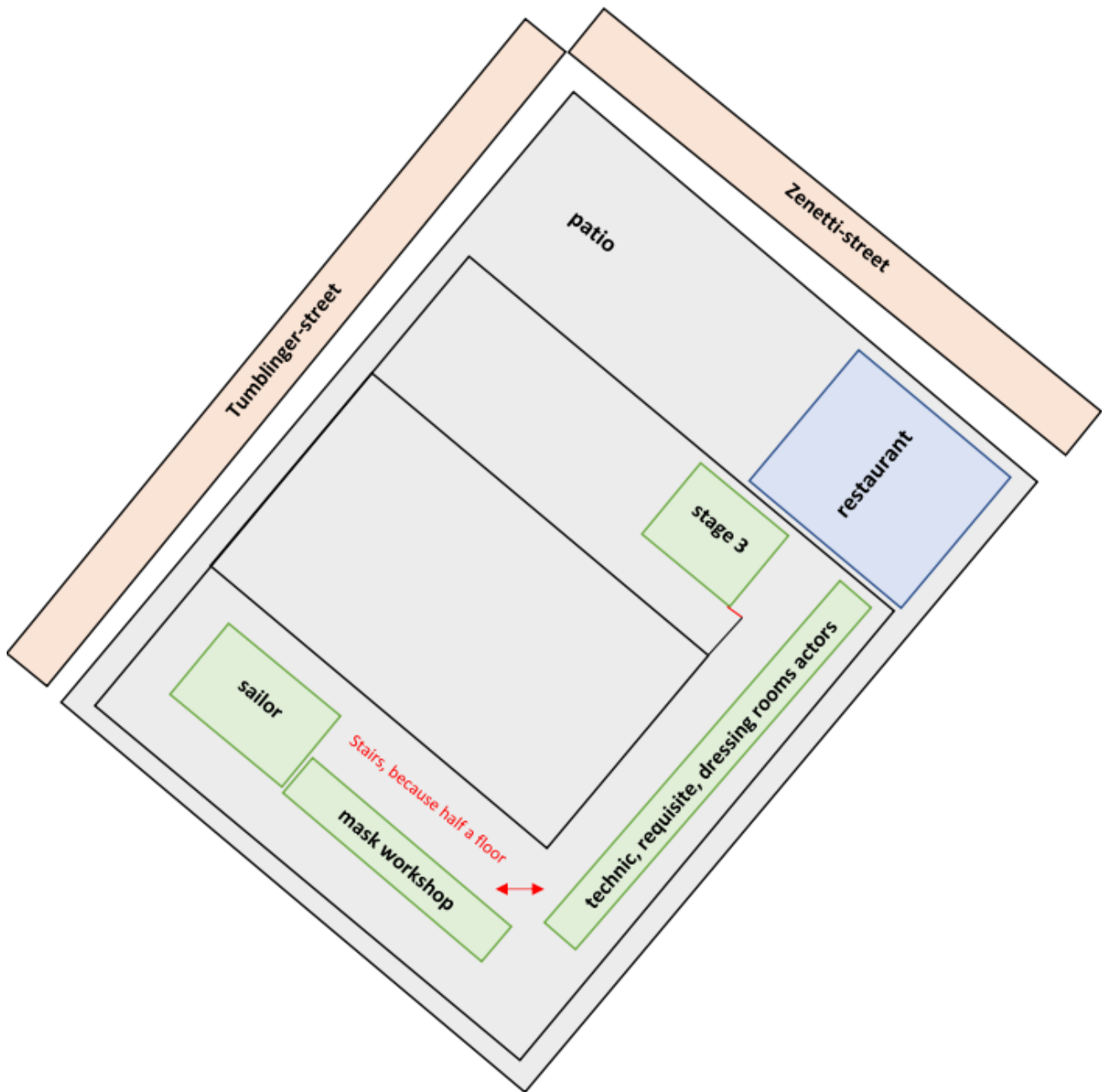

# volkstheater



We would love to keep in touch with you on Social Media! Tag us and share #radikaljung2024

 @volkstheater

 @volkstheater

 @volkstheater