

# volkstheater

Welcome to Radikal jung festival 2026!

We are glad that you're part of it!

FAQs

**volkstheater** BR2

24/4 - 3/5/2026

# RADIKAL JUNG

DAS FESTIVAL FÜR JUNGE REGIE

KARTEN 089.5 23 46 55 · [WWW.MUENCHNER-VOLKSTHEATER.DE](http://WWW.MUENCHNER-VOLKSTHEATER.DE)

## Why do I need a festival pass?

First of all: To be recognized as a member of the festival! At the SCHMOCK theatre restaurant, you can order drinks at a 20% discount when you show your festival pass, as well as a theatre meal: 2 different daily specials, one vegetarian meal for €6.50 and one with meat or fish for €7.00. In addition, sandwiches will be available daily during the festival for €4.50, as well as fries with ketchup and mayo for €5.90.

So, please always have your festival pass with you and show it to the waiter **prior to ordering**.

## Where is the theatre cafeteria?

We don't have a cafeteria, we have the theater restaurant SCHMOCK.

Self-service is available in the courtyard at the beer tables and in the front part of the restaurant.

There is a 2€ deposit on glasses, plates and cups. Please remember the deposit chip(s) when returning them!

## What are the opening hours of SCHMOCK?

The kitchen is open as follows:

Fri 24.04. 11:30-22:30	last order 22:15
Sat 25.04. 14:00-23:30	last order 23:15
Sun 26.04. 14:00-22:30	last order 22:15
Mon 27.04. 11:30-22:30	last order 22:15
Tue 28.04. 11:30-22:00	last order 21:45
Wed 29.04. 11:30-23:00	last order 22:45
Thu 30.04. 11:30-23:30	last order 23:15
Fri 01.05. 14:00-23:00	last order 22:45
Sat 02.05. 14:00-23:00	last order 22:45
Sun 03.05. 14:00-22:30	last order 22:15

Last orders are always 15 minutes before the kitchen closes:

If you can't make it by then, you can pre-order food at the bar in Schmock until 21:30. The kitchen staff will then heat up your food after the kitchen closes. Just show your order at the bar, and the server will collect your food from the kitchen.

Please keep in mind that one hour prior to the performances the restaurant is packed with people and it may be difficult to have a quick meal. We recommend to eat beforehand or to order the food in advance. The complete menu can be found on the [festival page](#).

**Important information:** On Saturdays, Sundays, and public holidays, food is available from 14:00, however, Schmock is not officially open yet. As an exception, you can enter Schmock through the small door behind the bar in the foyer and order your food directly from the kitchen staff.

## Celebratory Moment

After every artist talk we offer a little moment of celebration: inside the festival tent we will have glasses and sparkling wine (with and without alcohol) ready for you.

## Where is the stage entry?

The stage entrance is located at the south corner of the building. From Zenettistraße, go through the iron gate onto the grounds and walk along the theater to the corner, then turn right into the small courtyard. The second glass door on the right leads to the stage door (doorman Ben Alishev). This is the entrance to the building.

From the foyer, opposite the bar, you can access the cloakroom corridor and the backstage of stage 1 through a salmon-colored door with an electronic door opener. The door opens if you push the button on the right side of the door.

## Is there WIFI available?

Yes! In the theatre there is WIFI available, called MVT-Gast, password: volkstheater

## Where can I get help?

You can find all important contacts in the telephone list on the Radikal jung website at:

<https://www.muenchner-volkstheater.de/radikal-jung-team-2026>

## Where can I get my merch?

Visit our merch station located in the foyer of the Volkstheater!

The merch station is open as follows:

**Fr 24.4.** | 13:00-15:00

**Sa 25.4.** | 12:00-14:00

**So 26.4.** | closed

**Mo 27.4.** | closed

**Di 28.4.** | 16:00-18:00

**Mi 29.4.** | closed

**Do 30.4.** | 14:30-16:30

**Fr 01.05.** | 15:30-16:30

**Sa 02.05.** | 14:30-15:30

**So 03.05.** | 15:00-16:00

## #radikaljung2026

We would love to keep in touch with you on social media! Tag us and share #radikaljung2026



@volkstheater



@Münchner Volkstheater

## Site map

Main entrance: Tumblingerstraße 29, 80337 München

Stage entrance: Tumblingerstraße 31a (Access via Zenettistraße 21.)

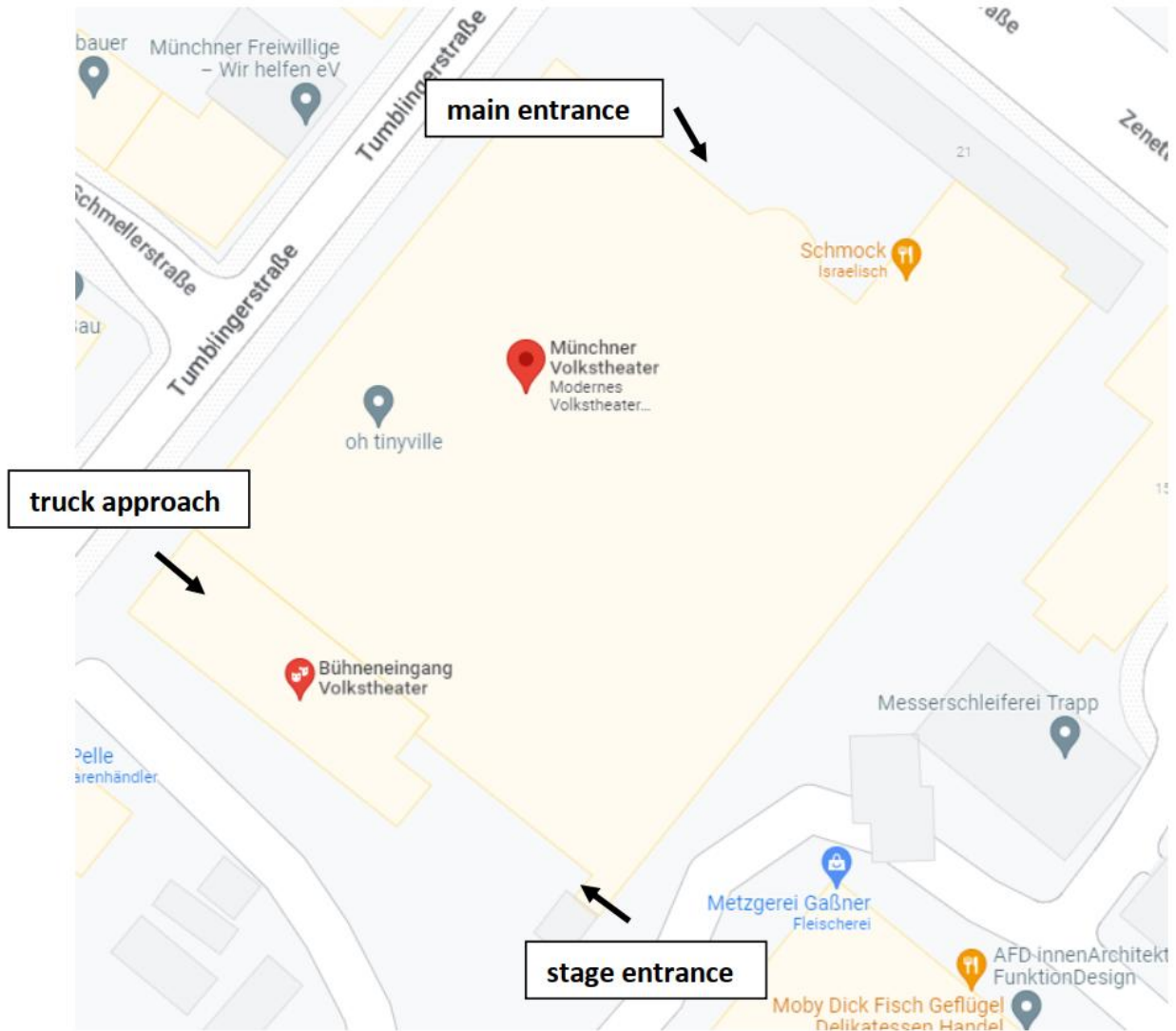

## Ground floor:

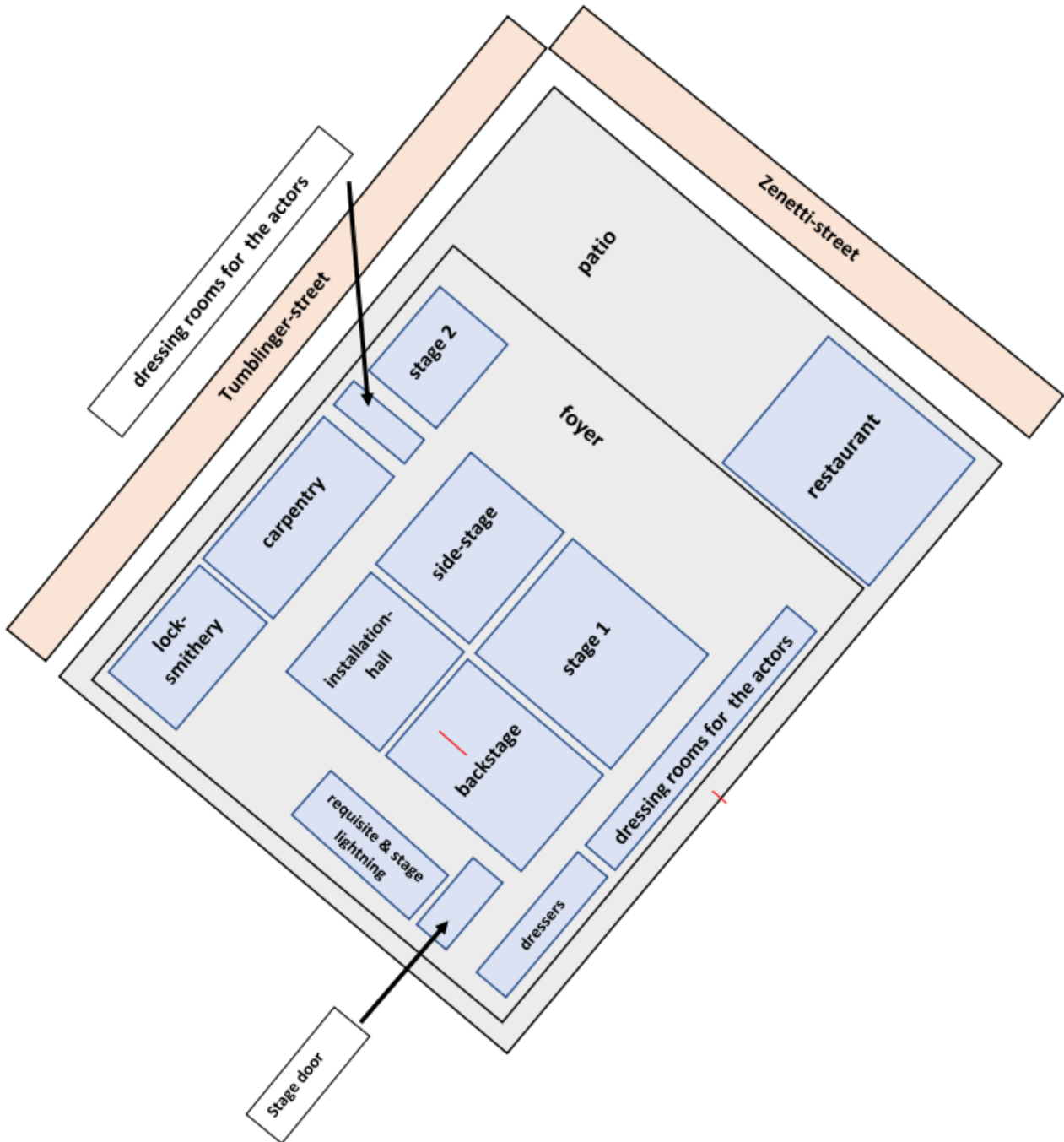

# volkstheater

First floor:

